

Technical Documentation

EasyConn PB Connect & Detect

General Information

The bus plug **EasyConn** connects PROFIBUS user knots or complete PROFIBUS net components to the PROFIBUS line. Switchable terminating resistors, a PD/diagnosis socket as well as a controller with 4 LED indicators are integrated.

Features

- Diagnosis functions via LEDs
- Programming/diagnostic plug integrated
- Switchable terminating resistors
- Integrated controller for transfer rates up to 12 Mbaud
- Metal casing with non-losable “one-screw-mounting”
- Connection via insulation cutting clamps for elastic and non-elastic bus cables

Diagnosis via LEDs

While connected, the **EasyConn** Profibus-plug offers the following test functions for start-up and trouble shooting – indicated by LEDs as below, whereas the grey background is the basic condition.

Name	Color	LED Off	LED On	LED flashing with 5 Hz
PWR	Yellow	No Power Supply of Controller	Self-Testing finished, controller under supply	Profibus-Master failed or short-circuit of wire!
TxD	Green	No bus activity	–	Data transfer
Term	Yellow	No termination	termination active	internal terminating resistors faulty!
ERR	Red	No errors	Faulty bus termination(s) in the bus line	Signal levels out of defined range

Switchable terminating resistors

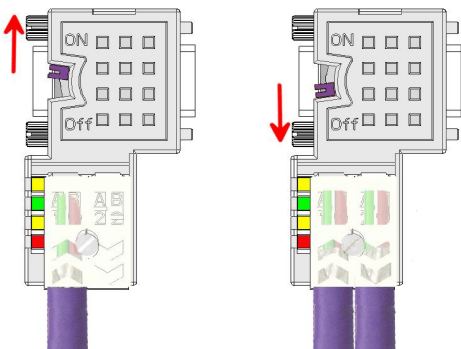

The switchable terminating resistors will be activated by a slide switch accessible from both sides right and rear.

With this, shutoff of the outgoing bus line is possible. Also for testing purpose the following PROFIBUS components can be switched off without removing the plug.

Stripping the cable

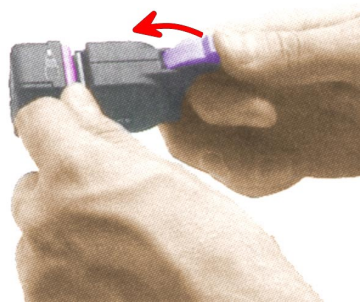
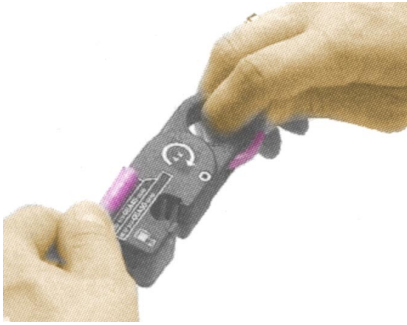

- Measure wire length on template:

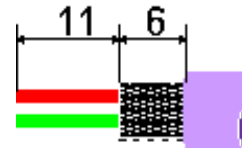

- Insert end of cable and fix it tightly until stop

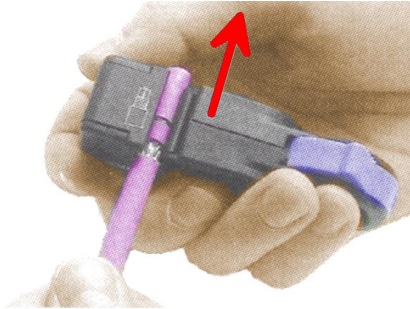
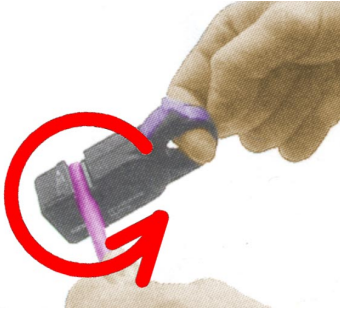

- Turn the stripping tool repeatedly around the cable
- Pull off in closed state
- Remove wire protection film and wire-soul

Connecting the profibus cable

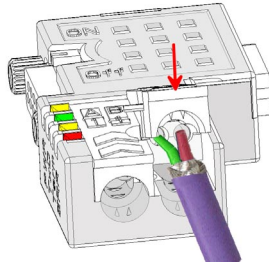
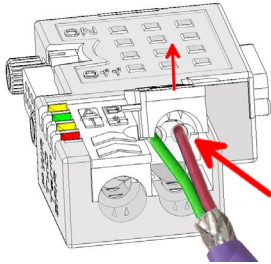

- Loosen the screw
- Lift contact-cover
- Push the 2 wires into the ducts provided (pay attention to the color code!)
- Close the contact-cover
- Tighten screw

Please note: the **green** line must be connected to „A“, the **red** line to „B“!

Technical data

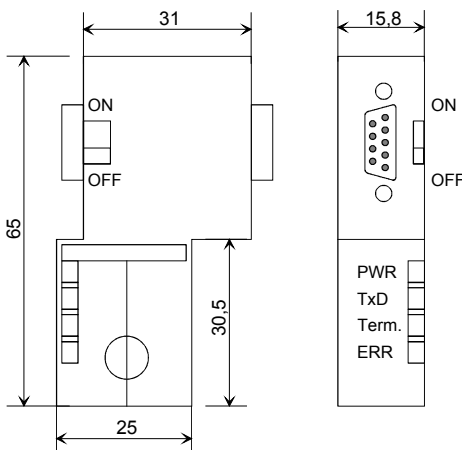

Connections	
Profibus	SubD-male – 9 pole
Programming Device/Diagnosis	SubD-female – 9 pole
Plugging Cycles	min. 200
Cable Diameter	8 mm
Caseing	Zinc-Diecast
Temperature Range	-20°C ... +75°C
Stripping Lengths	
Outside cover/shielding	19mm / 7mm
Connecting technique	Insulation cutting clamps
Bus cable	Typ A (EN50170)